

MOVT-HSW-C4

DS-545

1RPM SWEEP SECOND MOVEMENT

97 West Street, Medfield, MA 02052

p: 508.359.4396 f: 508.359.4482

www.electrictime.com

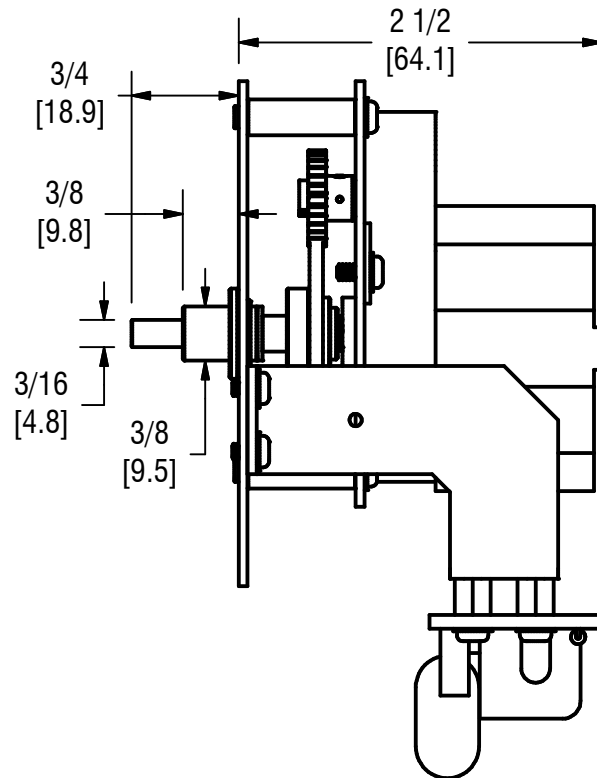
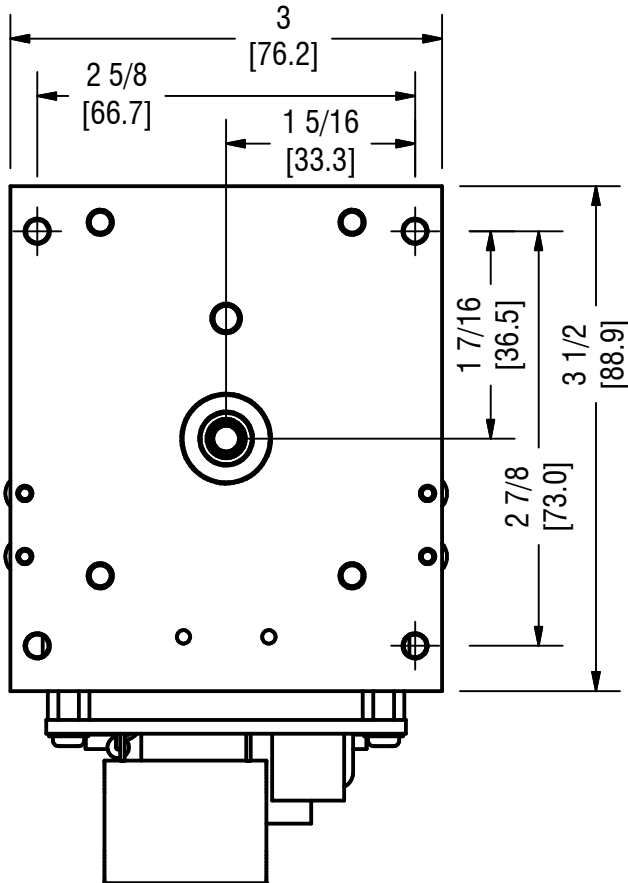

MECHANICAL SPECIFICATIONS

- SINGLE SHAFT OUTPUT
- UP TO Ø30" [760] DIAL WITH UNPROTECTED HAND (INDOORS ONLY)
- CONSULT ELECTRIC TIME CO. FOR RECOMMENDED MOVEMENT AND HAND MOUNTING PROCEDURES
- APPROXIMATE WEIGHT = .75LB [.34KG]
- CONTACT ETC FOR ADDITIONAL SHAFT LENGTH REQUIREMENTS

ELECTRICAL SPECIFICATIONS

- 24VAC-50/60 Hz-1.5W MOTOR (CONTINUOUS RUN)
- OPERATES WITH USE OF SWEEP SECOND OUTPUT ON 99B-MI CLOCK CONTROLLER OR 24VAC POWER SUPPLY (BY OTHERS)

